

# LOW PROFILE



FILTER AREA - 3.95 SQ IN

### HOW TO ORDER

1. TOP	MPT(RVM) 1/4(44)	FPT(RVLF) 3/8(66)	HB(RVB) 1/2(88)
	POLY(P)		NYLON(N)
2. GASKET	EPDM(E)	VITON(V)	BUNA(B)
3. SCREEN	20M(20)	40M(40)	80M(80)
4. BOWL	POLY(P)	NYLON(N)	CLEAR(C)

EXAMPLE: RVM 44 P E 40 P

## POLYPRO (L.P. Standard Assy)

ListEA  
**\$ 9.40**

1. POLY TOP (RVM)
2. EPDM OR BUNA GASKET (RVM44GB OR E)
3. 20,40, OR 80 MESH SCREEN (RVM44 \_)
4. CLEAR BOWL (RVM44BC)

### OPTIONS

- |                                    |          |
|------------------------------------|----------|
| 1. FEMALE TOPS (RVLF)              | add 1.10 |
| 1. BARB TOP (RVB)                  | add .62  |
| 2. VITON GASKET (RVM44GV)          | add 1.25 |
| 3. 20, 40, OR 80 MESH CAGED SCREEN | add .71  |
| 3. 250 MESH CAGED SCREEN           | add 1.50 |
| 4. POLY BOWL (RVM44BP)             | add .27  |

## NYLON (L.P. Standard Assy)

ListEA  
**\$ 9.40**

1. NYLON TOP (RVM)
2. EPDM OR BUNA GASKET (RVM44GB OR E)
3. 20,40, OR 80 MESH SCREEN (RVM44 \_)
4. CLEAR BOWL (RVM44BC)

### OPTIONS

- |                                    |          |
|------------------------------------|----------|
| 1. FEMALE TOPS (RVLF)              | add 2.69 |
| 1. BARB TOP (RVB)                  | add .62  |
| 2. VITON GASKET (RVM44GV)          | add 1.25 |
| 3. 20, 40, OR 80 MESH CAGED SCREEN | add .71  |
| 3. 250 MESH CAGED SCREEN           | add 1.50 |
| 4. NYLON BOWL (RVM44BN)            | add 1.32 |

### CAGED SCREENS (MESH)

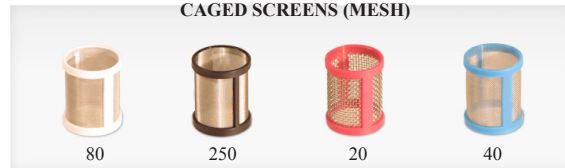

### LOW PROFILE STRAINER PARTS

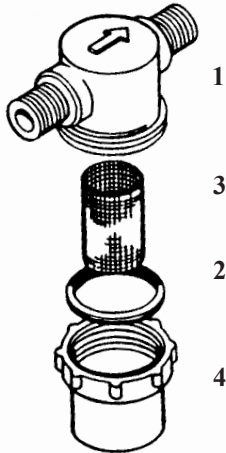

COMPONENT(1)	SIZE/PORT	NYLON #	LIST/EA	POLYPRO #	LIST/EA	
TOP	1/8" MPT	RVM22TN	3.84	RVM22TP	3.84	
TOP	1/4" MPT	RVM44TN	3.84	RVM44TP	3.84	
TOP	3/8" MPT	RVM66TN	3.84	RVM66TP	3.84	
TOP	1/2" MPT	RVM88TN	3.84	RVM88TP	3.84	
TOP	1/4" HB	RVB44TN	4.46	RVB44TP	4.46	
TOP	3/8" HB	RVB66TN	4.46	RVB66TP	4.46	
TOP	1/2" HB	RVB88TN	4.46	RVB88TP	4.46	
TOP	1/8" FPT	RVLF22TN	6.53	RVLF22TP	4.94	
TOP	1/4" FPT	RVLF44TN	6.53	RVLF44TP	4.94	
TOP	3/8" FPT	RVLF66TN	6.53	RVLF66TP	4.94	
TOP	1/2" FPT	RVLF88TN	6.53	RVLF88TP	4.94	
COMPONENT(2)	MATERIAL	TEMP MIN	COLOR	PART #	LIST/EA	
GASKET	BUNA	0 F	BLACK	RVM44GB	.43	
GASKET	EPDM	-40 F	RED	RVM44GE	.43	
GASKET	VITON	10 F	GREEN	RVM44GV	1.68	
COMPONENT(3)	MATERIAL	MESH*	MICRON+	ID" x L"	PART #	LIST/EA
SCREEN	ST STEEL	20	915	.94 x 1.34	RVM4420	1.81
SCREEN	ST STEEL CAGED	20	915	"	RVM4420C	2.52
SCREEN	ST STEEL	40	480	"	RVM4440	1.81
SCREEN	ST STEEL CAGED	40	480	"	RVM4440C	2.52
SCREEN	ST STEEL	80	178	"	RVM4480	1.81
SCREEN	ST STEEL CAGED	80	178	"	RVM4480C	2.52
SCREEN	ST STEEL	100	80	"	RVM44100	4.27
SCREEN	ST STEEL	250	40	"	RVM44250	4.81
SCREEN	ST STEEL CAGED	250	40	"	RVM44250C	3.31
SCREEN	POLYETH	90			RVM4490PE	3.22
COMPONENT(4)	MATERIAL	PART #	LIST/EA			
BOWL	NYLON	RVM44BN	4.63			
BOWL	POLYPRO	RVM44BP	3.58			
BOWL	CLEAR NYLON	RVM44BC	3.31			

\*Mesh is defined as the number of wires per linear inch measured from center of wire to center of wire.

+Micron is defined as one thousandth of a millimeter.

# MINI STRAINER



FILTER AREA - 7.71 SQ IN

## HOW TO ORDER

1. TOP	MPT(RVM) 1/4(445)	FPT(RVLF) 3/8(665)	HB(RVB) 1/2(885)
	POLY(P)    NYLON(N)		
2. GASKET	EPDM(E)	VITON(V)	BUNA(B)
3. SCREEN	20M(20)	40M(40)	80M(80)
4. BOWL	POLY(P)	NYLON(N)	CLEAR(C)

EXAMPLE: RVM 445 P E 40 P

## POLYPRO (Standard Assy)

ListEA  
**\$ 12.97**

1. POLY TOP (RVM)
2. EPDM OR BUNA GASKET (RVM44GB OR E)
3. 20 OR 40 MESH SCREEN (RVM445 \_\_)
4. CLEAR BOWL (RVM445BC)

### OPTIONS

- |                                   |          |
|-----------------------------------|----------|
| 1. FEMALE TOPS (RVLF)             | add 1.10 |
| 1. BARB TOP (RVB)                 | add .62  |
| 2. VITON GASKET (RVM44GV)         | add 1.25 |
| 3. 80 MESH STAINLESS SCREEN       | add .49  |
| 3. 20,40, OR 80 MESH CAGED SCREEN | add .36  |
| 3. 250 MESH CAGED SCREEN          | add 1.37 |
| 4. POLY BOWL (RVM445BP)           | add .84  |

## NYLON (Standard Assy)

ListEA  
**\$ 15.66**

1. NYLON TOP (RVM)
2. EPDM OR BUNA GASKET (RVM44GB OR E)
3. 20 OR 40 MESH SCREEN (RVM445 \_\_)
4. CLEAR BOWL (RVM445BC)

### OPTIONS

- |                                   |          |
|-----------------------------------|----------|
| 1. FEMALE TOPS (RVLF)             | add 2.69 |
| 1. BARB TOP (RVB)                 | add .62  |
| 2. VITON GASKET (RVM44GV)         | add 1.25 |
| 3. 80 MESH STAINLESS SCREEN       | add .49  |
| 3. 20,40, OR 80 MESH CAGED SCREEN | add .36  |
| 3. 250 MESH CAGED SCREEN          | add 1.37 |
| 4. NYLON BOWL (RVM445BN)          | add 6.84 |

### CAGED SCREENS (MESH)

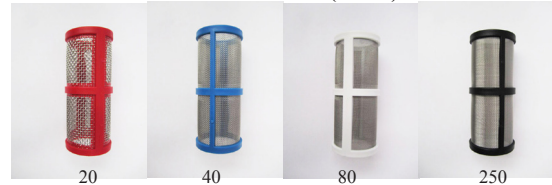

MINI STRAINER PARTS						
COMPONENT(1)	SIZE/PORT	NYLON #	LIST/EA	POLYPRO #	LIST/EA	
TOP	1/8" MPT	RVM22TN	3.84	RVM22TP	3.84	
TOP	1/4" MPT	RVM44TN	3.84	RVM44TP	3.84	
TOP	3/8" MPT	RVM66TN	3.84	RVM66TP	3.84	
TOP	1/2" MPT	RVM88TN	3.84	RVM88TP	3.84	
TOP	1/4" HB	RVB44TN	4.46	RVB44TP	4.46	
TOP	3/8" HB	RVB66TN	4.46	RVB66TP	4.46	
TOP	1/2" HB	RVB88TN	4.46	RVB88TP	4.46	
TOP	1/8" FPT	RVLF22TN	6.53	RVLF22TP	4.94	
TOP	1/4" FPT	RVLF44TN	6.53	RVLF44TP	4.94	
TOP	3/8" FPT	RVLF66TN	6.53	RVLF66TP	4.94	
TOP	1/2" FPT	RVLF88TN	6.53	RVLF88TP	4.94	
COMPONENT(2)	MATERIAL	TEMP MIN	COLOR	PART #	LIST/EA	
GASKET	BUNA	0 F	BLACK	RVM44GB	.43	
GASKET	EPDM	-40 F	RED	RVM44GE	.43	
GASKET	VITON	10 F	GREEN	RVM44GV	1.68	
COMPONENT(3)	MATERIAL	MESH*	MICRON+	ID" x L"	PART #	LIST/EA
SCREEN	ST STEEL	20	915	.94 x 2.63	RVM44520	2.56
SCREEN	ST STEEL CAGED	20	915	"	RVM44520C	2.92
SCREEN	ST STEEL	40	480	"	RVM44540	2.56
SCREEN	ST STEEL CAGED	40	480	"	RVM44540C	2.92
SCREEN	ST STEEL	80	178	"	RVM44580	3.05
SCREEN	ST STEEL CAGED	80	178	"	RVM44580C	2.92
SCREEN	ST STEEL	250	40	"	RVM445250	12.97
SCREEN	ST STEEL CAGED	250	40	"	RVM445250C	3.93
COMPONENT(4)	MATERIAL	PART #	LIST/EA			
BOWL	NYLON	RVM445BN	7.28			
BOWL	POLYPRO	RVM445BP	6.97			
BOWL	CLEAR NYLON	RVM445BC	6.13			

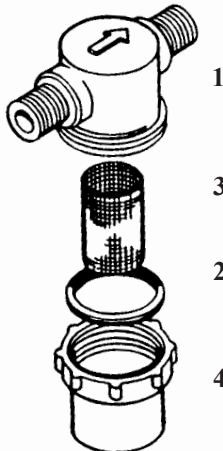

\*Mesh is defined as the number of wires per linear inch measured from center of wire to center of wire.

+Micron is defined as one thousandth of a millimeter.

MINI STRAINER

# INTERMEDIATE



FILTER AREA - 17.33 SQ IN

### HOW TO ORDER

1. TOP	FPT(RVF) 3/8"(66)	TAB(RVT-POLY ONLY) 1/2"(88)	3/4"(1212)
	POLY(P)	NYLON(N)	
2. GASKET	EPDM(E)	VITON(V)	BUNA(B)
3. SCREEN	20M(20)	40M(40)	80M(80)
4. BOWL	POLY(P)	NYLON(N)	CLEAR(C)

EXAMPLE: RVF 88 N V 40 C

## POLYPRO (Standard Assembly) List/EA

**\$ 15.22**

1. POLY TOP (RVF )
2. EPDM GASKET(RVF66GE)
3. 20 OR 40 MESH SCREEN(RVF66\_ )
4. POLY BOWL(RVF66BP)

### OPTIONS

- |                                      |          |
|--------------------------------------|----------|
| 1. TAB TOP (RVT)                     | add .84  |
| 2. BUNA GASKET (RVF66GB)             | add .35  |
| 2. VITON GASKET (RVF66GV)            | add 2.95 |
| 3. 80 MESH SCREEN (RVF6680S)         | add .75  |
| 3. 20,40, OR 80 MESH CAGED SCREEN    | add .22  |
| 3. 100 MESH SCREEN (RVF66100)        | add 1.90 |
| 3. 250 MESH CAGED SCREEN (RVF66250C) | add 2.52 |
| 3. CAGED POLY SCREEN (RVF66_P)       | add 4.46 |
| 4. CLEAR NYLON BOWL (RVF66BC)        | add 7.23 |

## NYLON (Standard Assembly) List/EA

**\$ 21.35**

1. NYLON TOP (RVF )
2. EPDM OR BUNA GASKET(RVF66GB OR E)
3. 20 OR 40 MESH SCREEN(RVF66\_ )
4. NYLON BOWL (RVF66BN)

### OPTIONS

- |                                      |          |
|--------------------------------------|----------|
| 2. BUNA GASKET (RVF66GB)             | add .35  |
| 2. VITON GASKET (RVF66GV)            | add 2.95 |
| 3. 80 MESH SCREEN (RVF6680S)         | add .75  |
| 3. 20, 40, OR 80 MESH CAGED SCREEN   | add .22  |
| 3. 100 MESH SCREEN (RVF66100)        | add 1.90 |
| 3. 250 MESH CAGED SCREEN (RVF66250C) | add 2.52 |
| 4. CLEAR NYLON BOWL (RVF66BC)        | add 5.07 |

### CAGED SCREENS (MESH)

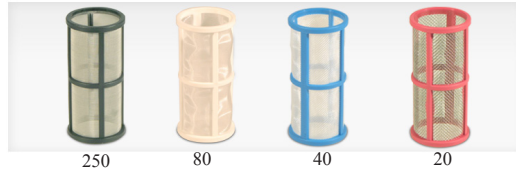

### INTERMEDIATE STRAINER PARTS

COMPONENT(1)	SIZE/PORT	NYLON #	PRICE	POLYPRO #	LIST/EA	
1	TOP	3/8" FPT	RVF66TN	9.35	RVF66TPN	5.38
	TOP	1/2" FPT	RVF88TN	9.35	RVF88TPN	5.38
	TOP	3/4" FPT	RVF1212TN	9.35	RVF1212TPN	5.38
	TOP	1" FPT	RVF1616TN*	9.35	RVF1616TP*	5.38
2	TOP	3/8" FPT TAB		RVT66TP	6.22	
	TOP	1/2" FPT TAB		RVT88TP	6.22	
	TOP	3/4" FPT TAB		RVT1212TP	6.22	
COMPONENT(2)	MATERIAL	TEMP MIN	COLOR	PART #	LIST/EA	
GASKET	BUNA	0 F	BLACK	RVF66GB	.93	
GASKET	EPDM	-40 F	RED	RVF66GE	.58	
GASKET	VITON	10 F	GREEN	RVF66GV	3.53	
COMPONENT(3)	MATERIAL	MESH*	MICRON+	ID" x L"	PART #	LIST/EA
SCREEN	ST STEEL	20	915	1.49 x 3.75	RVF6620S	3.44
SCREEN	ST STEEL	40	480	"	RVF6640S	3.44
SCREEN	ST STEEL	80	178	"	RVF6680S	4.19
SCREEN	ST STEEL	100	80	"	RVF66100	5.34
SCREEN	ST STEEL	250	40	"	RVF66250	16.27
SCREEN	POLYETHYLENE		90	1.00 x 3.52	RVF6690PE	6.31
SCREEN	CAGED ST	20	915	1.49 x 3.75	RVF6620C	3.66
SCREEN	CAGED ST	40	480	"	RVF6640C	3.66
SCREEN	CAGED ST	80	178	"	RVF6680C	3.66
SCREEN	CAGED ST	250	40	"	RVF66250C	5.96
SCREEN	CAGED POLY	20	915	"	RVF6620P	7.90
SCREEN	CAGED POLY	40	480	"	RVF6640P	7.90
SCREEN	CAGED POLY	80	178	"	RVF6680P	7.90
*Mesh is defined as the number of wires per linear inch measured from center of wire to center of wire.						
+Micron is defined as one thousandth of a millimeter						
COMPONENT(4)	MATERIAL	COLOR	PART #	LIST/EA		
BOWL	NYLON	WHITE	RVF66BN	7.99		
BOWL	POLYPRO	BLACK	RVF66BP	5.83		
BOWL	CLEAR NYLON	CLEAR	RVF66BC	13.06		





**SUCTION LINE STRAINERS**  
 MOLDED PVC BASE  
 ST. STEEL SCREENS

<i>Fpt</i>	<i>Mesh</i>	<i>Part #</i>	<i>List/E</i>
1/4	20	RV663-20	4.90
1/4	40	RV663	4.90
1/4	80	RV663-80	4.90
1/4	100	RV663-100	5.35
3/8	40	RV6631	5.40
3/8	80	RV6631-80	5.40
1/2	40	RV6632	6.45
1/2	80	RV6632-80	6.45
3/4	40	RV6633	7.05
1	40	RV6634	10.25
1 1/2	40	RV6636	12.10



**Y STRAINERS**  
 POLYPROPYLENE BODY  
 EPDM GASKET  
 (VITON AVAILABLE)  
 ST. STEEL SCREENS  
 FPT THREADS

<i>Fpt</i>	<i>Part #</i>	<i>List/E</i>
1/2	YST88PE_P	60.03
3/4	YST1212PE_P	60.03
1	YST1616PE_P	60.03
1 1/4	YST2020PE_P	60.03
1 1/2	YST2424PE_P	132.13
2	YST3232PE_P	132.13
3	YST4848PE_P	800.55

Please specify screen when ordering. See parts list below for sizes.

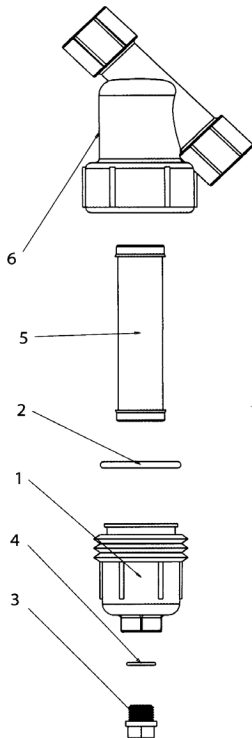

**Y STRAINER PARTS**

COMPONENT(1,2,6)		SIZE		PART #	LIST/E
BODY, CAP & EPDM GASKET		1/2		YST88-B/C	29.57
BODY, CAP & EPDM GASKET		3/4		YST1212-B/C	29.57
BODY, CAP & EPDM GASKET		1		YST1616-B/C	29.57
BODY, CAP & EPDM GASKET		1 1/4		YST2020-B/C	29.57
BODY, CAP & EPDM GASKET		1 1/2		YST2424-B/C	66.34
BODY, CAP & EPDM GASKET		2		YST3232-B/C	66.34
BODY, CAP & EPDM GASKET		3		YST4848-B/C	595.68
COMPONENT(2) MATERIAL		SIZE		PART #	LIST/E
GASKET	VITON	1/2 & 3/4		YST88-GV	10.00
GASKET	VITON	1 & 1 1/4		YST1616-GV	11.00
GASKET	VITON	1 1/2 & 2		YST2424-GV	21.56
GASKET	VITON	3		YST4848-GV	57.39
COMPONENT(5) MAT		SIZE	MESH MICRON	PART #	LIST/E
SCREEN	ST STEEL	1/2 & 3/4	20 841	YST188-20	37.57
SCREEN	"	"	40 446	YST88-40	34.13
SCREEN	"	"	80 177	YST88-80	37.57
SCREEN	ST STEEL	1 & 1 1/4	20 841	YST1616-20	37.57
SCREEN	"	"	40 446	YST1616-40	37.57
SCREEN	"	"	80 177	YST1616-80	34.13
SCREEN	ST STEEL	1 1/2 & 2	6 3360	YST3232-6	74.30
SCREEN	"	"	8 2380	YST3232-8	73.36
SCREEN	"	"	12 1680	YST3232-12	67.54
SCREEN	"	"	20 841	YST3232-20	67.54
SCREEN	"	"	30 595	YST3232-30	67.54
SCREEN	"	"	50 297	YST3232-50	67.54
SCREEN	"	"	80 177	YST3232-80	67.54
SCREEN	"	"	120 116	YST3232-120	74.30
SCREEN	POLYPRO	"	20 841	YST3232-20P	67.54
SCREEN	POLYPRO	"	50 297	YST3232-50P	67.54
SCREEN	ST STEEL	3	4	YST4848-4	223.74
SCREEN	"	"	8 2380	YST4848-8	223.74
SCREEN	"	"	12 1680	YST4848-12	223.74
SCREEN	"	"	20 841	YST4848-20	203.39
SCREEN	"	"	50 297	YST4848-50	203.39